

Notes:

1. Refer to D252-09-211 for additional UL1480 product label (limited to the model numbers described in the drawing)
2. Enclosure entries may differ depending on product options

RELATED DRAWING
No modification permitted without reference to the "Authorised Person"

ISSUE	MOD No.	INITIAL/DATE
1		INTRODUCTION MA 30-10-2023

D2xL1-R008-A
D2xL1FR008AB1A1R

8 Ohm Loudspeaker 15W
Input: 8 Ohm
Power: 15W
Max IP Voltage: 10.95Vrms

Entries - Twin: M20x1.5 / Single: 1/2" NPT
Use heat resistant cables and cable glands (rated 90°C)
IP66/67
Type 4 / 4X / 3R / 13
Year / Serial No.: 00/01D31/00000

WARNING: DO NOT OPEN WHEN ENERGISED. DO NOT OPEN WHEN AN EXPLOSIVE ATMOSPHERE IS PRESENT. POTENTIAL ELECTROSTATIC CHARGING HAZARD - CLEAN ONLY WITH DAMP CLOTH.

AVERTISSEMENT: NE PAS OUVRIR ENERGIÉ. NE PAS OUVRIR UN PRÉSENCE D'ATMOSPHÈRE EXPLOSIVE. DANGER POTENTIEL CHARGE ÉLECTROSTATIQUE - NETTOYER UNIQUEMENT AVEC UN CHIFFON HUMIDE.

Impress House, Mansell Rd, London UK, W3 7QH www.e2s.com

D2xL1FR008
Label 1

D2xL1-R008-A
D2xL1FR008AB1A1R

US (NEC) CLASS ZONE
Class I Zone 2 AEx ec IIC T3 Gc Ta -55°C to +75°C
Class I Zone 2 AEx ec IIC T4 Gc Ta -55°C to +50°C
Zone 22 AEx tc IIC T109°C Dc Ta -55°C to +75°C

ATEX / IECEx / UKEx
Ex ec IIC T3 Gc Ta -55°C to +75°C
Ex ec IIC T4 Gc Ta -55°C to +50°C
Ex tc IIC T109°C Dc Ta -55°C to +75°C

DEMKO 14 ATEX 478649304X
IECEx ULD 14.0004X
UL21UKEx2131X

US (NEC) CLASS DIV
Class I Div 2 ABCD T3B Ta -55°C to +85°C
Class I Div 2 ABCD T3C Ta -55°C to +80°C
Class I Div 2 ABCD T4 Ta -55°C to +50°C
Class I Div 2 ABCD T4A Ta -55°C to +40°C
Class II Div 2 FG T4 Ta -55°C to +85°C
Class III Ta -55°C to +85°C

CE UK CA UL CERTIFIED E230764

Impress House, Mansell Rd, London UK, W3 7QH www.e2s.com

D2xL1FR008
Label 2

D2xL1-R016-A
D2xL1FR016AB1A1R

16 Ohm Loudspeaker 15W
Input: 16 Ohm
Power: 15W
Max IP Voltage: 15.49Vrms

Entries - Twin: M20x1.5 / Single: 1/2" NPT
Use heat resistant cables and cable glands (rated 90°C)
IP66/67
Type 4 / 4X / 3R / 13
Year / Serial No.: 00/01D32/00001

WARNING: DO NOT OPEN WHEN ENERGISED. DO NOT OPEN WHEN AN EXPLOSIVE ATMOSPHERE IS PRESENT. POTENTIAL ELECTROSTATIC CHARGING HAZARD - CLEAN ONLY WITH DAMP CLOTH.

AVERTISSEMENT: NE PAS OUVRIR ENERGIÉ. NE PAS OUVRIR UN PRÉSENCE D'ATMOSPHÈRE EXPLOSIVE. DANGER POTENTIEL CHARGE ÉLECTROSTATIQUE - NETTOYER UNIQUEMENT AVEC UN CHIFFON HUMIDE.

Impress House, Mansell Rd, London UK, W3 7QH www.e2s.com

D2xL1FR016
Label 1

D2xL1-R016-A
D2xL1FR016AB1A1R

US (NEC) CLASS ZONE
Class I Zone 2 AEx ec IIC T3 Gc Ta -55°C to +75°C
Class I Zone 2 AEx ec IIC T4 Gc Ta -55°C to +50°C
Zone 22 AEx tc IIC T109°C Dc Ta -55°C to +75°C

ATEX / IECEx / UKEx
Ex ec IIC T3 Gc Ta -55°C to +75°C
Ex ec IIC T4 Gc Ta -55°C to +50°C
Ex tc IIC T109°C Dc Ta -55°C to +75°C

DEMKO 14 ATEX 478649304X
IECEx ULD 14.0004X
UL21UKEx2131X

US (NEC) CLASS DIV
Class I Div 2 ABCD T3B Ta -55°C to +85°C
Class I Div 2 ABCD T3C Ta -55°C to +80°C
Class I Div 2 ABCD T4 Ta -55°C to +50°C
Class I Div 2 ABCD T4A Ta -55°C to +40°C
Class II Div 2 FG T4 Ta -55°C to +85°C
Class III Ta -55°C to +85°C

CE UK CA UL CERTIFIED E230764

Impress House, Mansell Rd, London UK, W3 7QH www.e2s.com

D2xL1FR016
Label 2

D2xL1-V100-A
D2xL1FV100AB1A1R

100V Line In Loudspeaker 15W
Input: 100V Line
Power: 15W
Max IP Voltage: 100Vrms

Entries - Twin: M20x1.5 / Single: 1/2" NPT
Use heat resistant cables and cable glands (rated 90°C)
IP66/67
Type 4 / 4X / 3R / 13
Year / Serial No.: 00/01D33/00002

WARNING: DO NOT OPEN WHEN ENERGISED. DO NOT OPEN WHEN AN EXPLOSIVE ATMOSPHERE IS PRESENT. POTENTIAL ELECTROSTATIC CHARGING HAZARD - CLEAN ONLY WITH DAMP CLOTH.

AVERTISSEMENT: NE PAS OUVRIR ENERGIÉ. NE PAS OUVRIR UN PRÉSENCE D'ATMOSPHÈRE EXPLOSIVE. DANGER POTENTIEL CHARGE ÉLECTROSTATIQUE - NETTOYER UNIQUEMENT AVEC UN CHIFFON HUMIDE.

Impress House, Mansell Rd, London UK, W3 7QH www.e2s.com

D2xL1FV100
Label 1

D2xL1-V100-A
D2xL1FV100AB1A1R

US (NEC) CLASS ZONE
Class I Zone 2 AEx ec IIC T3 Gc Ta -55°C to +75°C
Class I Zone 2 AEx ec IIC T4 Gc Ta -55°C to +50°C
Zone 22 AEx tc IIC T109°C Dc Ta -55°C to +75°C

ATEX / IECEx / UKEx
Ex ec IIC T3 Gc Ta -55°C to +75°C
Ex ec IIC T4 Gc Ta -55°C to +50°C
Ex tc IIC T109°C Dc Ta -55°C to +75°C

DEMKO 14 ATEX 478649304X
IECEx ULD 14.0004X
UL21UKEx2131X

US (NEC) CLASS DIV
Class I Div 2 ABCD T3B Ta -55°C to +85°C
Class I Div 2 ABCD T3C Ta -55°C to +80°C
Class I Div 2 ABCD T4 Ta -55°C to +50°C
Class I Div 2 ABCD T4A Ta -55°C to +40°C
Class II Div 2 FG T4 Ta -55°C to +85°C
Class III Ta -55°C to +85°C

CE UK CA UL CERTIFIED E230764

Impress House, Mansell Rd, London UK, W3 7QH www.e2s.com

D2xL1FV100
Label 2

D2xL1-V725-A
D2xL1FV725AB1A1R

70.725V Line In Loudspeaker 15W
Input: 70.725V Line
Power: 15W
Max IP Voltage: 70.7Vrms or 25Vrms

Entries - Twin: M20x1.5 / Single: 1/2" NPT
Use heat resistant cables and cable glands (rated 90°C)
IP66/67
Type 4 / 4X / 3R / 13
Year / Serial No.: 00/01D35/00004

WARNING: DO NOT OPEN WHEN ENERGISED. DO NOT OPEN WHEN AN EXPLOSIVE ATMOSPHERE IS PRESENT. POTENTIAL ELECTROSTATIC CHARGING HAZARD - CLEAN ONLY WITH DAMP CLOTH.

AVERTISSEMENT: NE PAS OUVRIR ENERGIÉ. NE PAS OUVRIR UN PRÉSENCE D'ATMOSPHÈRE EXPLOSIVE. DANGER POTENTIEL CHARGE ÉLECTROSTATIQUE - NETTOYER UNIQUEMENT AVEC UN CHIFFON HUMIDE.

Impress House, Mansell Rd, London UK, W3 7QH www.e2s.com

D2xL1FV725
Label 1

D2xL1-V725-A
D2xL1FV725AB1A1R

US (NEC) CLASS ZONE
Class I Zone 2 AEx ec IIC T3 Gc Ta -55°C to +75°C
Class I Zone 2 AEx ec IIC T4 Gc Ta -55°C to +50°C
Zone 22 AEx tc IIC T109°C Dc Ta -55°C to +75°C

ATEX / IECEx / UKEx
Ex ec IIC T3 Gc Ta -55°C to +75°C
Ex ec IIC T4 Gc Ta -55°C to +50°C
Ex tc IIC T109°C Dc Ta -55°C to +75°C

DEMKO 14 ATEX 478649304X
IECEx ULD 14.0004X
UL21UKEx2131X

US (NEC) CLASS DIV
Class I Div 2 ABCD T3B Ta -55°C to +85°C
Class I Div 2 ABCD T3C Ta -55°C to +80°C
Class I Div 2 ABCD T4 Ta -55°C to +50°C
Class I Div 2 ABCD T4A Ta -55°C to +40°C
Class II Div 2 FG T4 Ta -55°C to +85°C
Class III Ta -55°C to +85°C

CE UK CA UL CERTIFIED E230764

Impress House, Mansell Rd, London UK, W3 7QH www.e2s.com

D2xL1FV725
Label 2

DRAWING TO BS8888:2000
GEOMETRIC TOLERANCES TO ISO1101:1983
LINEAR DIMENSIONAL TOLS +/-0.35mm
ANGULAR DIMENSIONAL TOLS +/-2 deg

DRAWN M.ABALOS DATE 30-10-2023

CHECKED R.N.POTTS DATE 30-10-2023

APPROVED R.N.POTTS DATE 30-10-2023

SURFACE FINISH WEIGHT (Kg)

MATERIAL SEE NOTE

ALTERNATIVE MATERIAL

THIS DRAWING AND ANY INFORMATION OR DESCRIPTIVE MATTER THEREIN IS COMMUNICATED IN CONFIDENCE AND IS THE COPYRIGHT PROPERTY OF EUROPEAN SAFETY SYSTEMS LTD. NEITHER THE WHOLE OR ANY EXTRACT MAY BE DISCLOSED, LOANED, COPIED OR USED FOR MANUFACTURING OR TENDERING PURPOSES WITHOUT THEIR WRITTEN CONSENT.

© EUROPEAN SAFETY SYSTEMS LTD.
AS PER LATEST DATE OF ISSUE SHOWN ABOVE



EUROPEAN SAFETY SYSTEMS LTD
IMPRESS HOUSE
MANSELL ROAD
ACTON
LONDON W3 7QH
WWW.E2S.COM

ALL DIMENSIONS IN MM
IF IN DOUBT, ASK -
DO NOT SCALE

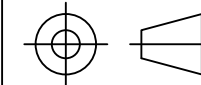

A3

TITLE D2xL1 & D2xL2 LOUDSPEAKER PRODUCT LABELS

SCALE 1:1

SHEET 1 of 3

DRAWING NUMBER D252-09-201

Notes:

1. Refer to D252-09-211 for additional UL1480 product label (limited to the model numbers described in the drawing)
2. Enclosure entries may differ depending on product options

RELATED DRAWING
No modification permitted without reference to the "Authorised Person"

ISSUE	MOD No.	INITIAL/DATE
1		INTRODUCTION MA 30-10-2023

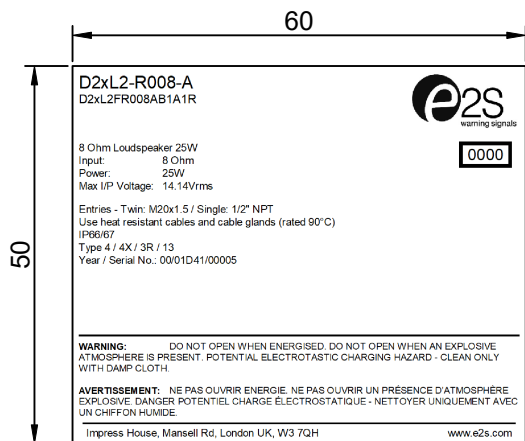

D2xL2FR008
Label 1

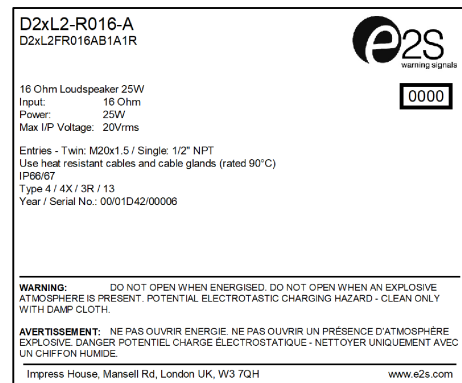

D2xL2FR016
Label 1

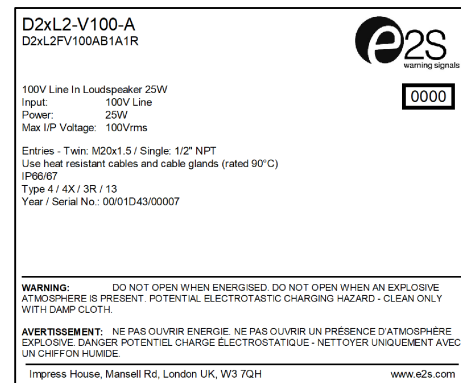

D2xL2FV100
Label 1

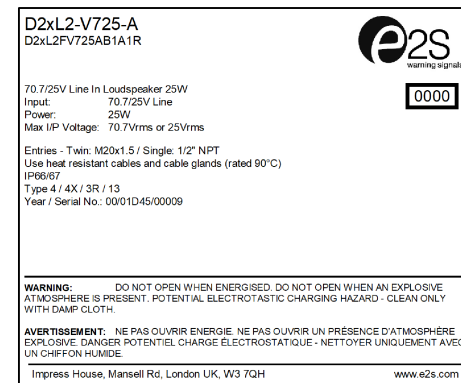

D2xL2FV725
Label 1

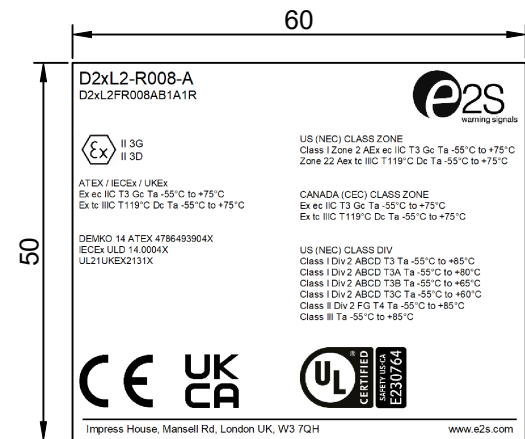

D2xL2FR008
Label 2

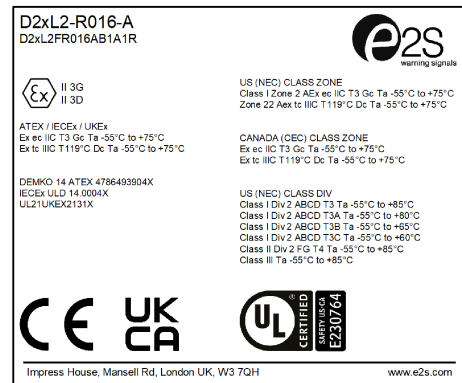

D2xL2FR016
Label 2

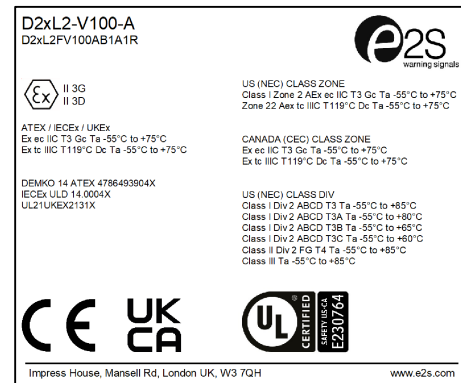

D2xL2FV100
Label 2

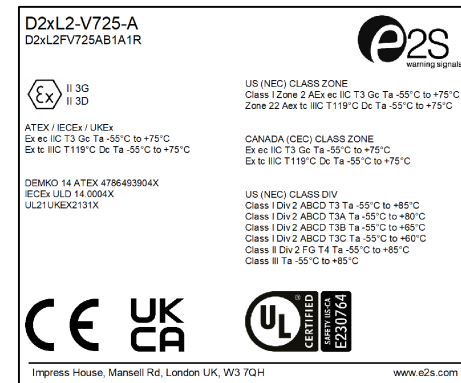

D2xL2FV725
Label 2

DRAWING TO BS8888:2000
GEOMETRIC TOLERANCES TO ISO1101:1983
LINEAR DIMENSIONAL TOLS +/-0.35mm
ANGULAR DIMENSIONAL TOLS +/-2 deg

DRAWN M.ABALOS DATE 30-10-2023

CHECKED R.N.POTTS DATE 30-10-2023

APPROVED R.N.POTTS DATE 30-10-2023

SURFACE FINISH WEIGHT (Kg)

MATERIAL SEE NOTE

ALTERNATIVE MATERIAL

THIS DRAWING AND ANY INFORMATION OR DESCRIPTIVE MATTER THEREIN IS COMMUNICATED IN CONFIDENCE AND IS THE COPYRIGHT PROPERTY OF EUROPEAN SAFETY SYSTEMS LTD. NEITHER THE WHOLE OR ANY EXTRACT MAY BE DISCLOSED, LOANED, COPIED OR USED FOR MANUFACTURING OR TENDERING PURPOSES WITHOUT THEIR WRITTEN CONSENT.

© EUROPEAN SAFETY SYSTEMS LTD. AS PER LATEST DATE OF ISSUE SHOWN ABOVE



EUROPEAN SAFETY SYSTEMS LTD
IMPRESS HOUSE
MANSELL ROAD
ACTON
LONDON W3 7QH
WWW.E2S.COM

ALL DIMENSIONS IN MM
IF IN DOUBT, ASK - DO NOT SCALE

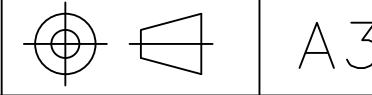

TITLE D2xL1 & D2xL2 LOUDSPEAKER PRODUCT LABELS

SCALE 1:1 SHEET 2 of 3 DRAWING NUMBER D252-09-201

Notes:

1. Refer to D252-09-211 for additional UL1480 product label (limited to the model numbers described in the drawing)
2. Enclosure entries may differ depending on product options

RELATED DRAWING
No modification permitted without reference to the "Authorised Person"

ISSUE	MOD No.	INITIAL/DATE
1		INTRODUCTION MA 30-10-2023

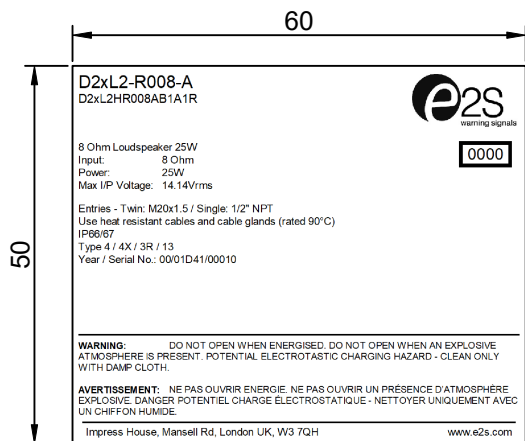

D2xL2HR008
Label 1

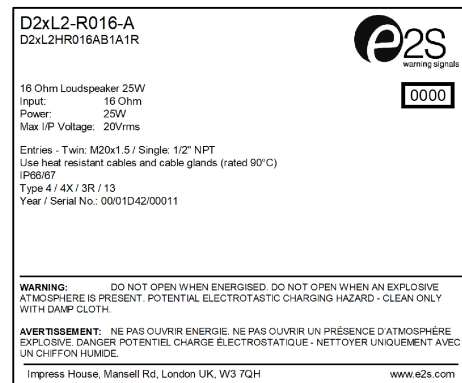

D2xL2HR016
Label 1

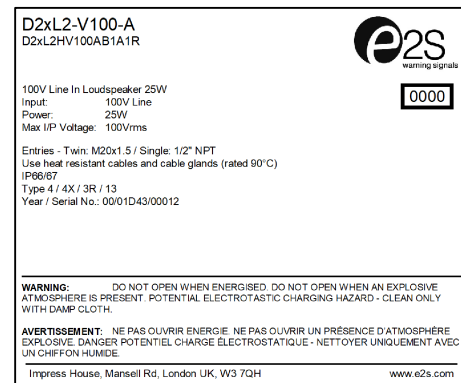

D2xL2HV100
Label 1

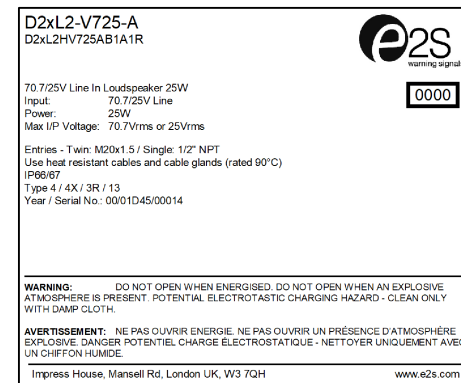

D2xL2HV725
Label 1

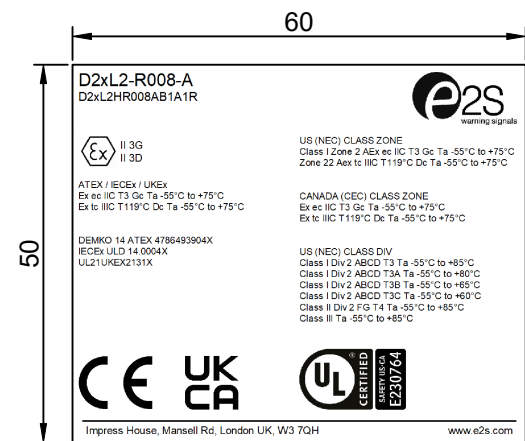

D2xL2HR008
Label 2

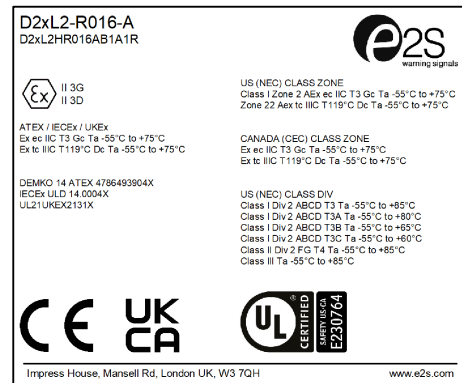

D2xL2HR016
Label 2

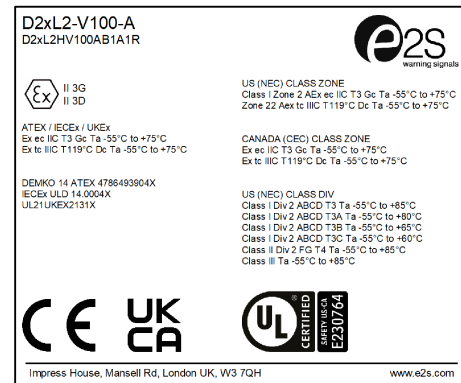

D2xL2HV100
Label 2

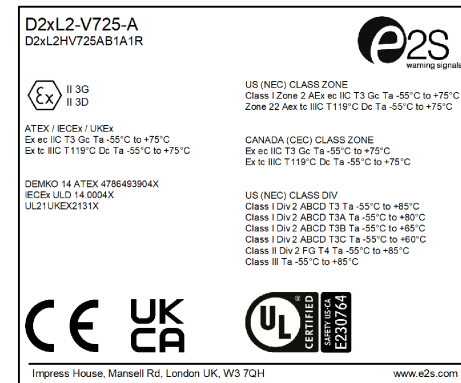

D2xL2HV725
Label 2

DRAWING TO BS8888:2000
GEOMETRIC TOLERANCES TO ISO1101:1983
LINEAR DIMENSIONAL TOLS +/-0.35mm
ANGULAR DIMENSIONAL TOLS +/-2 deg

DRAWN
M.ABALOS
DATE
30-10-2023

CHECKED
R.N.POTTS
DATE
30-10-2023

APPROVED
R.N.POTTS
DATE
30-10-2023

STANDARDS
D2x

SURFACE FINISH

WEIGHT (Kg)

MATERIAL

SEE NOTE

ALTERNATIVE MATERIAL

THIS DRAWING AND ANY INFORMATION OR DESCRIPTIVE MATTER THEREIN IS COMMUNICATED IN CONFIDENCE AND IS THE COPYRIGHT PROPERTY OF EUROPEAN SAFETY SYSTEMS LTD. NEITHER THE WHOLE OR ANY EXTRACT MAY BE DISCLOSED, LOANED, COPIED OR USED FOR MANUFACTURING OR TENDERING PURPOSES WITHOUT THEIR WRITTEN CONSENT.

© EUROPEAN SAFETY SYSTEMS LTD.
AS PER LATEST DATE OF ISSUE SHOWN ABOVE



EUROPEAN SAFETY SYSTEMS LTD
IMPRESS HOUSE
MANSELL ROAD
ACTON
LONDON W3 7QH
WWW.E2S.COM

ALL DIMENSIONS IN MM
IF IN DOUBT, ASK -
DO NOT SCALE

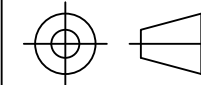

A3

TITLE
D2xL1 & D2xL2 LOUDSPEAKER PRODUCT LABELS

SCALE
1:1

SHEET
3 of 3

DRAWING NUMBER
D252-09-201