

ISSUE:	MOD No.	INITIAL/DATE
A		INTRODUCTION OF PART DAH 26-05-2021

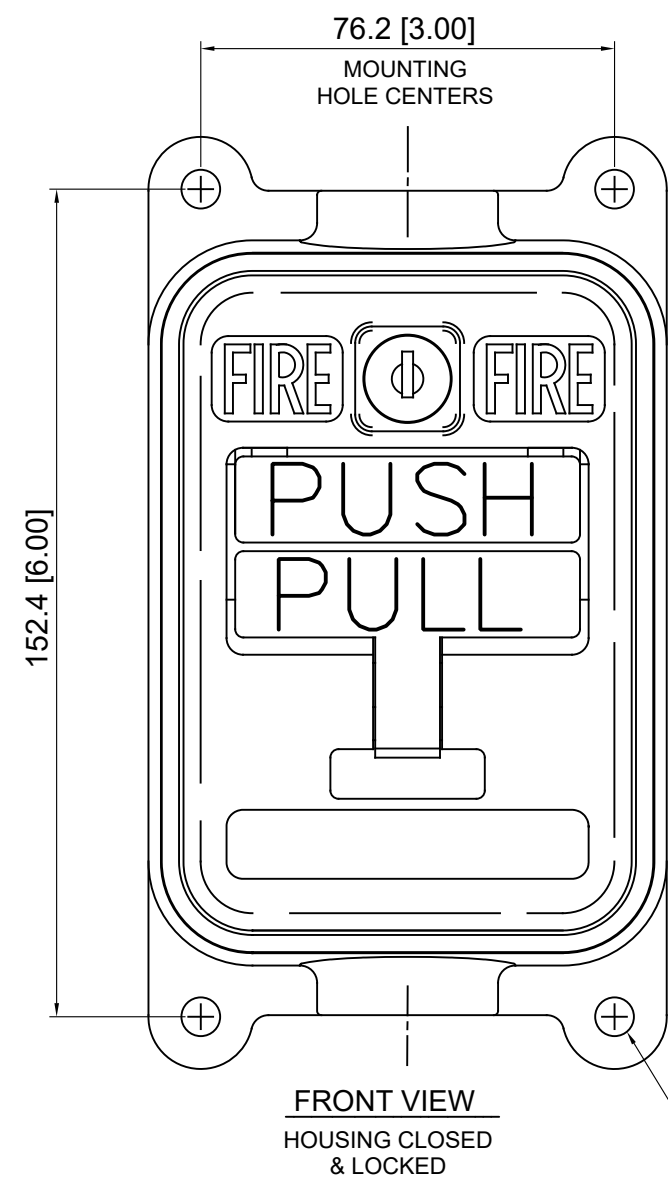

FRONT VIEW
HOUSING CLOSED
& LOCKED

Ø7.9 [0.310] THRU
4X

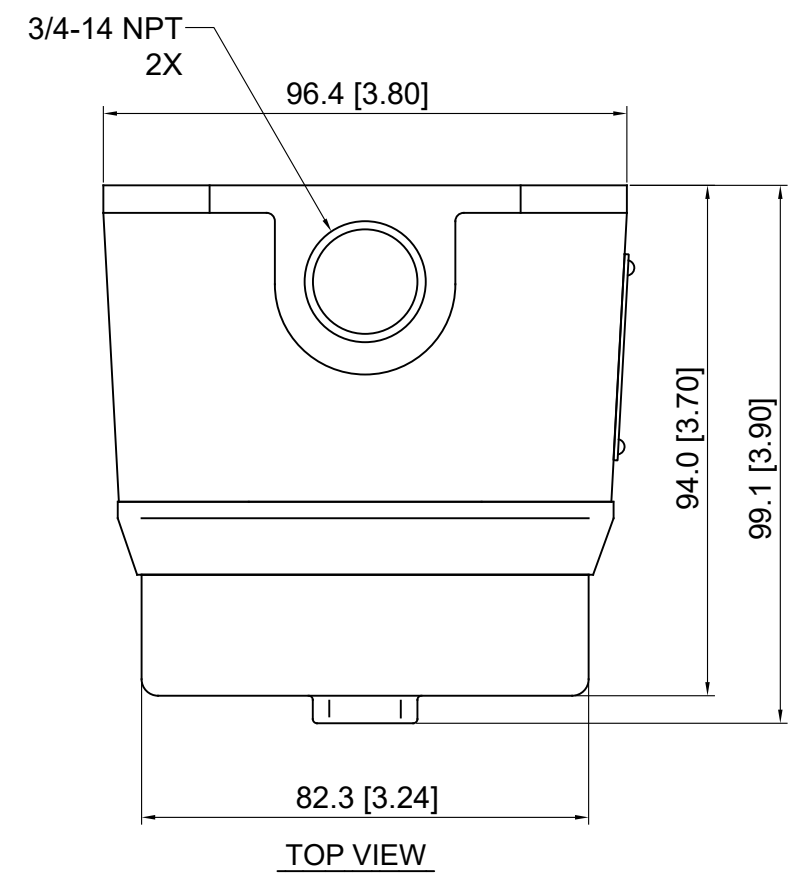
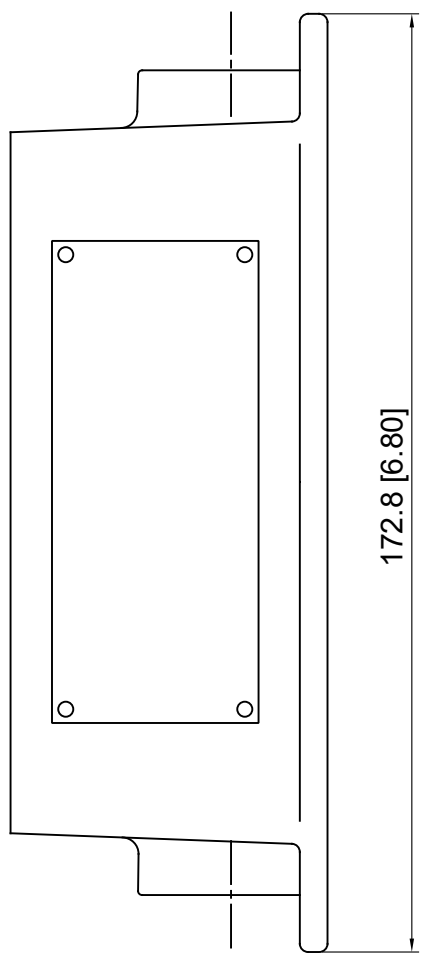
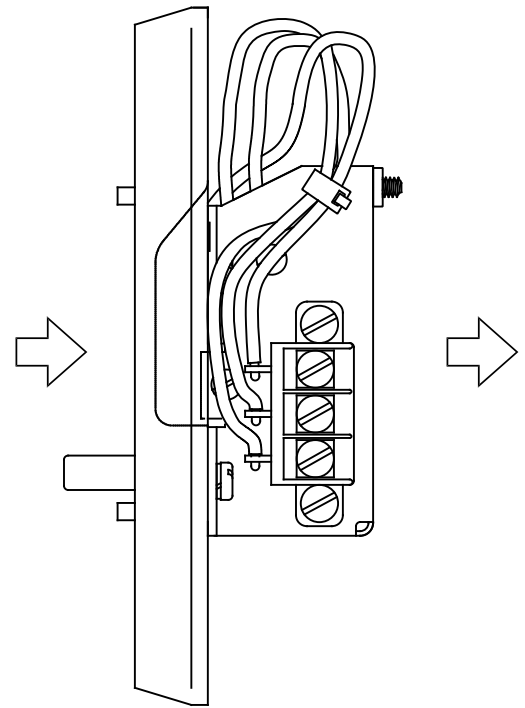
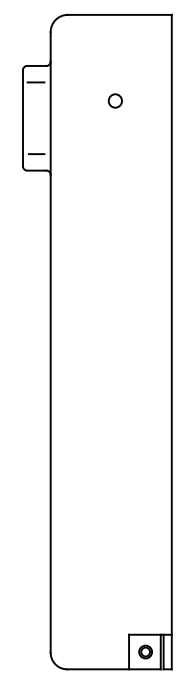

TOP VIEW

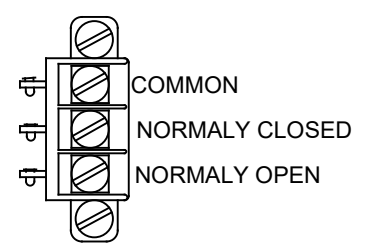
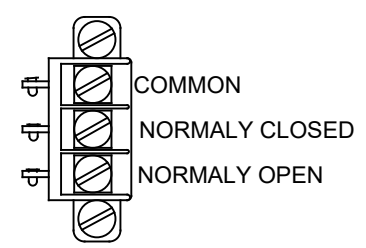

E2S PART NO.	DESCRIPTION	DATA REFERENCE
D1xCP1-PS	D1xCP1-PS Manual Pull Station	1-24-110

DIMENSIONS IN MM [INCHES]

DRAWING TO BS8888:2000 GEOMETRIC TOLERANCES TO ISO1101:1983 LINEAR DIMENSIONAL TOLS ANGULAR DIMENSIONAL TOLS	DRAWN D.HOWGILL	DATE 26-05-2021	SURFACE FINISH	WEIGHT (Kg)	THIS DRAWING AND ANY INFORMATION OR DESCRIPTIVE MATTER THEREIN IS COMMUNICATED IN CONFIDENCE AND IS THE COPYRIGHT PROPERTY OF EUROPEAN SAFETY SYSTEMS LTD. NEITHER THE WHOLE OR ANY EXTRACT MAY BE DISCLOSED, LOANED, COPIED OR USED FOR MANUFACTURING OR TENDERING PURPOSES WITHOUT THEIR WRITTEN CONSENT. EUROPEAN SAFETY SYSTEMS LTD. AS PER LATEST DATE OF ISSUE SHOWN ABOVE	 warning signals EUROPEAN SAFETY SYSTEMS LTD IMPRESS HOUSE MANSELL ROAD ACTON LONDON W3 7QH WWW.E2S.COM	ALL DIMENSIONS IN MM [IN] IF IN DOUBT, ASK - DO NOT SCALE	 A2
	CHECKED R.N.POTTS	DATE 26-05-2021	MATERIAL	TITLE D1xCP1-PS PULL STATION OUTLINE DRAWING				
	STANDARDS D1xCP1	APPROVED R.N.POTTS	DATE 26-05-2021	ALTERNATIVE MATERIAL			SCALE 1:1	