

Features

- Continuously rated.
- Large termination area.
- Stainless steel fixings.
- Ratchet adjustable stainless steel 'U' bracket for 360° positioning.
- Duplicate cable terminations (in & out for daisy-chain installations).
- Tropicalisation available on request.

Approvals

- GOST-R approved: POCC GB.JB05.H00144.



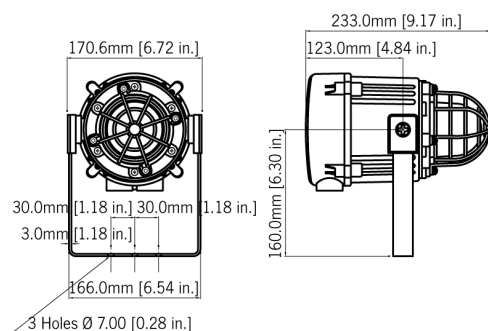

Specification

Light source:	Array of 32 high output L.E.D.s
Peak/Effective Intensity cd:	11 cd* – measured ref. to I.E.S.
Lens colours:	Amber, Blue, Green, Red & Yellow
Voltages DC:	10-50V dc
Voltages AC:	24V ac; 115V ac; 230V ac
Ingress protection:	IP66 & IP67 (Third party tested)
Housing material:	High impact UL94 V0 & 5VA FR ABS
Colour:	Grey (RAL7038)
Cable entries:	2 x M20 supplied with 1 blanking plug
Lens material:	Borosilicate glass dome with PC prismatic lens cover.
Guard:	Stainless Steel dome guard as standard
Terminals:	0.5 to 4.0mm ² cables.
Operating temp:	-25 to +55°C [-13 to +131°F]
Storage temp:	-40 to +70°C [-40 to +158°F]
Relative humidity:	90% at 20°C [68°F]
Weight:	1.48kg/3.25lbs
*Candela measurements representative of performance with clear lens at optimum voltage	

Part Codes

Version:	Part code:
24V dc	MBL1DC24G-xx
48V dc	MBL1DC24G-xx
24V ac	MBL1AC24G-xx
115V ac	MBL1AC115G-xx
230V ac	MBL1AC230G-xx
xx = L.E.D. / LensAM: Amber, BL: Blue, GN: Green, RD: Red, YW: Yellow colour:	

Current Consumption

Version:	Voltage:	Current mA:
24V dc	10-50V dc	400mA
48V dc	10-50V dc	230mA
24V ac	50/60Hz +/-10%	380mA
115V ac	50/60Hz +/-10%	140mA
230V ac	50/60Hz +/-10%	70mA

Multi-function patterns

Mode:	Stage 1: [Selectable on board]	Stage 2: [Remotely selectable]	Stage 3: [Remotely selectable]
1	All L.E.D's on	Alternate Side Flash 1:1 2Hz	Double Strike Flash 2Hz
2	Rotating: Fast 1	1x Flash 2Hz	All L.E.D's on
3	Rotating: Fast 2	Double Strike Flash 2Hz	All L.E.D's on
4	Rotating: Slow 1	Alternate Side Flash 1:1 2Hz	All L.E.D's on
5	Rotating: Slow 2	Double Strike Flash 1Hz	All L.E.D's on
6	Double Strike Flash 1Hz	Alternate Side Flash 1:1 2Hz	All L.E.D's on
7	Single Strike Flash 2Hz	Rotating: Fast 2	All L.E.D's on
8	Double Strike Flash 2Hz	Rotating: Fast 2	All L.E.D's on
9	Alternate Side Flash 1:1 2Hz	Rotating: Fast 2	All L.E.D's on