

A

AlertAlight

AL100X Combined Sounder Xenon Beacon
32 Selectable Tones & 3 Stages
5J Xenon Flash Tube
Three Modes: Flashing 1Hz (AC & DC Units),
Flashing 1.5Hz (DC Units Only),
Double Strike (DC Units Only).
Note: Only 1Hz Flashing mode is CPR approved.
Only 24V dc & 48V dc versions are CPR approved
CE
IP Rating: IP66

Order code	Voltage Range	Nominal Voltage	Sounder Current @Tone 2	Beacon Current
AL100XDC014[X]/[Y]	10-14V dc	12 V dc	25mA	500mA
AL100XDC024[X]/[Y]	20-28V dc	24 V dc	25mA	250mA
AL100XDC048[X]/[Y]	42-54V dc	48 V dc	50mA	175mA
AL100XAC024[X]/[Y]	24 ± 10% V ac	24 V ac	40mA	300mA
AL100XAC115[X]/[Y]	115 ± 10% V ac	115 V ac	20mA	70mA
AL100XAC230[X]/[Y]	230 ± 10% V ac	230 V ac	15mA	35mA

[X] Denotes Body Colour,
[Y] Denotes Lens Colour: Note CPR Approved units
only available in R = Red or C = Clear

Add '-UL' Suffix for UL Approved Units
(Type 4 / 4X / 3R / 13, IP66)

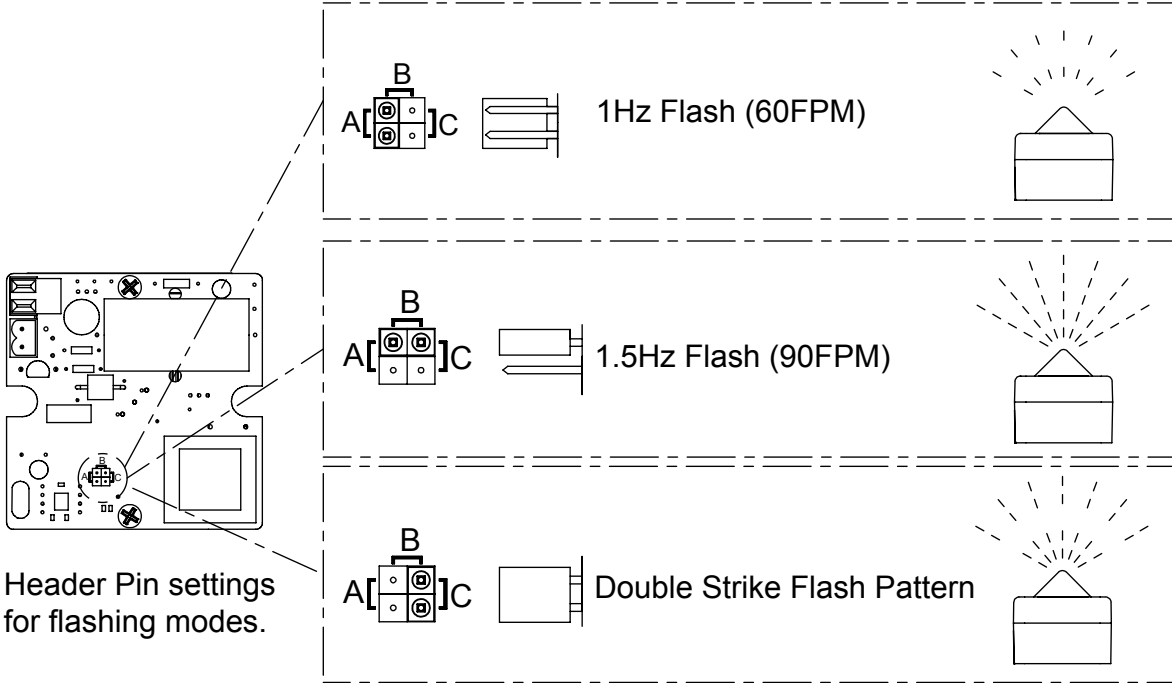
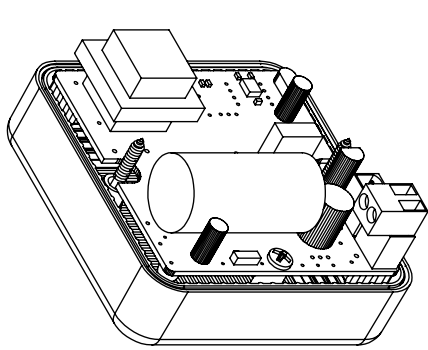

Tel : +44 (0)2 8743 8880 Fax : +44 (0)20 8740 4200
mail : sales@e2s.com web : www.e2s.com



B

- ATTENTION:** Installation must be carried out by an electrician in compliance with the latest codes and regulations.
- ATTENTION:** Disconnect from power source before installation or service to prevent electric shock.
- ATTENTION:** On strobe beacons allow a minimum of 2 minutes for hazardous high voltage to discharge from unit.



No liability is accepted for any consequences of the use of this document. The technical specification of this unit is subject to change without notice due to our policy of continual product development. All dimensions/weights are approximate. This unit is sold subject to our standard conditions of sale, a copy of which is available on request.

C

Table 1 - Tone Selection									
STAGE 1	FREQUENCY DESCRIPTION	dB(A)@ 1m		Switch				Stage 2	Stage 3
TONE 1	340 Hz Continuous	102						TONE 2	TONE 5
TONE 2	800/1000Hz @ 0.25 sec Alternating	106						TONE 17	TONE 5
TONE 3	500/1200Hz @ 0.3Hz 0.5 sec Slow Whoop	106						TONE 2	TONE 5
TONE 4	800/1000Hz @ 1Hz Sw eeping	106						TONE 6	TONE 5
TONE 5	2400Hz Continuous	112						TONE 3	TONE 20
TONE 6	2400/2900Hz @ 7Hz Sw eeping	108						TONE 7	TONE 5
TONE 7	2400/2900Hz @ 1Hz Sw eeping	108						TONE 10	TONE 5
TONE 8	500/1200/500Hz @ 0.3Hz Sw eeping	106						TONE 2	TONE 5
TONE 9	1200/500Hz @ 1Hz - DIN / PFEER P.T.A.P.	106						TONE 15	TONE 2
TONE 10	2400/2900Hz @ 2Hz Alternating	110						TONE 7	TONE 5
TONE 11	1000Hz @ 1Hz Intermittent	106						TONE 2	TONE 5
TONE 12	800/1000Hz @ 0.875Hz Alternating	106						TONE 4	TONE 5
TONE 13	2400Hz @ 1Hz Intermittent	112						TONE 15	TONE 5
TONE 14	800Hz 0.25sec on, 1 sec off Intermittent	108						TONE 15	TONE 5
TONE 15	800Hz Continuous	108						TONE 2	TONE 5
TONE 16	660Hz 150mS on, 150mS off Intermittent	104						TONE 18	TONE 5
TONE 17	544Hz (100mS)/440Hz (400mS) - NF S 32-001	104						TONE 2	TONE 27
TONE 18	660Hz 1.8sec on, 1.8sec off Intermittent	104						TONE 2	TONE 5
TONE 19	1.4KHz-1.6KHz 1s, 1.6KHz-1.4KHz 0.5s -NFC48-265	106						TONE 2	TONE 5
TONE 20	660Hz Continuous	104						TONE 2	TONE 5
TONE 21	554Hz/440Hz @ 1Hz Alternating	104						TONE 2	TONE 5
TONE 22	544Hz @ 0.875 sec. Intermittent	104						TONE 2	TONE 5
TONE 23	800Hz @ 2Hz Intermittent	108						TONE 6	TONE 5
TONE 24	800/1000Hz @ 50Hz Sw eeping	108						TONE 29	TONE 5
TONE 25	2400/2900Hz @ 50Hz Sw eeping	108						TONE 29	TONE 5
TONE 26	Bell	100						TONE 2	TONE 15
TONE 27	554Hz Continuous	104						TONE 26	TONE 5
TONE 28	440Hz Continuous	103						TONE 2	TONE 5
TONE 29	800/1000Hz @ 7Hz Sw eeping	105						TONE 7	TONE 5
TONE 30	300Hz Continuous	100						TONE 2	TONE 5
TONE 31	660/1200Hz @ 1Hz Sw eeping	105						TONE 26	TONE 5
TONE 32	Two tone chime.	103						TONE 26	TONE 15

NOTE: Please check factory settings and ensure the correct alarm tone is selected for your country or application

Tone Selection / Switch Setting - Switch settings are shown in the tone selection table. Black squares are the switch levers in the ON positions

Only tones 2, 3, 9, 15, 16 & 17 have been tested to EN54-3 and are compliant with the Construction Products Regulation 305/2011.

Reverse Polarity Switching - On DC versions the second stage alarm tone can be selected by reversing the polarity of the supply voltage if switch 6 is in the ON position and Link L1 is made.

DC Line Monitoring - Remove Link L1 for line monitoring, (DC supply only).

DC CIRCUIT

AC CIRCUIT

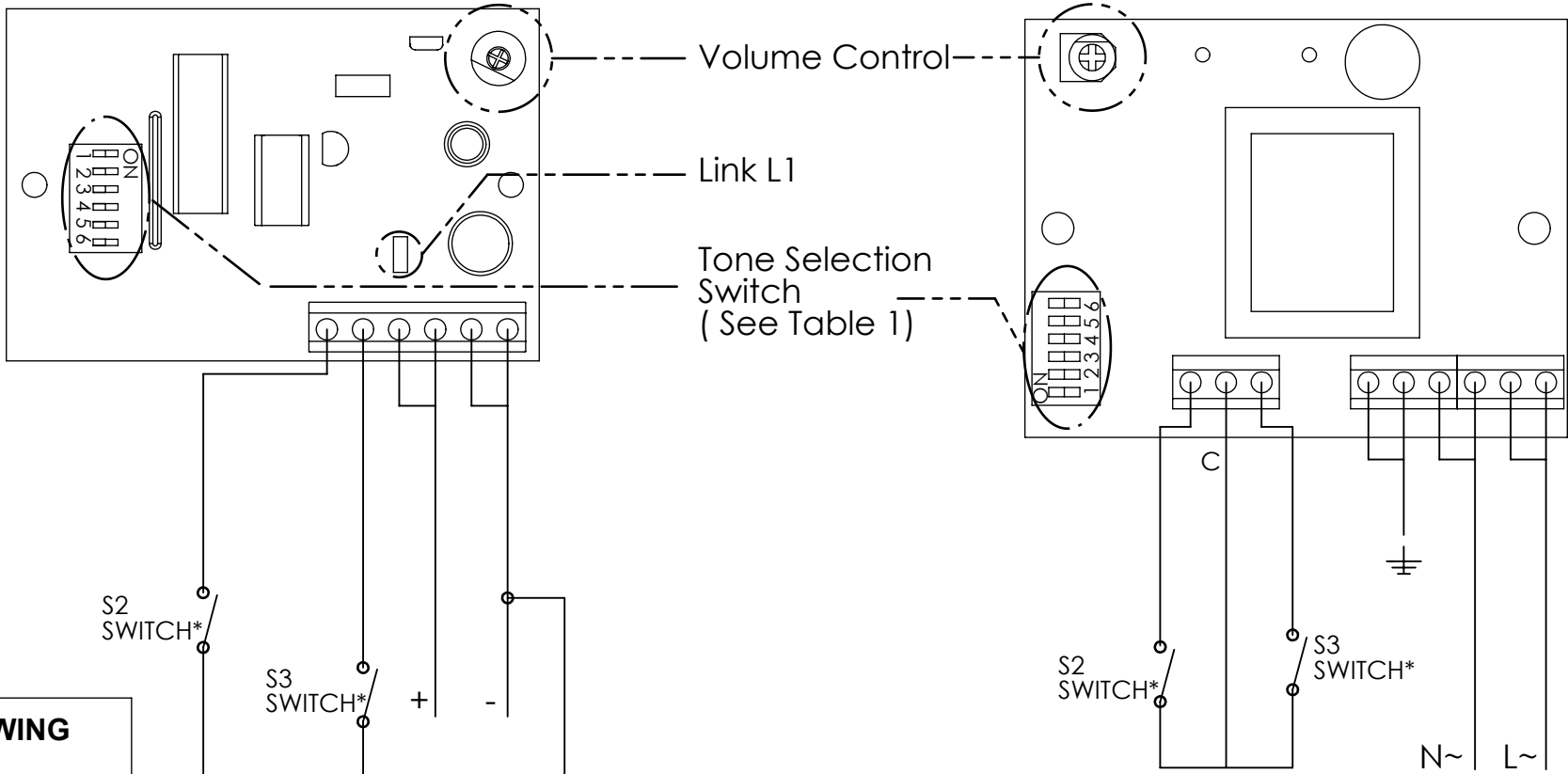

CPR FILE DRAWING

No modification permitted
without reference to
"VdS"

*S2 & S3 Denote Stage 2 & Stage 3 respectively
Stage switches are customer supplied

D177-00-501-IS-SC-CPR_SHT1_ISSUE_C



A AlertAlight
AL100X

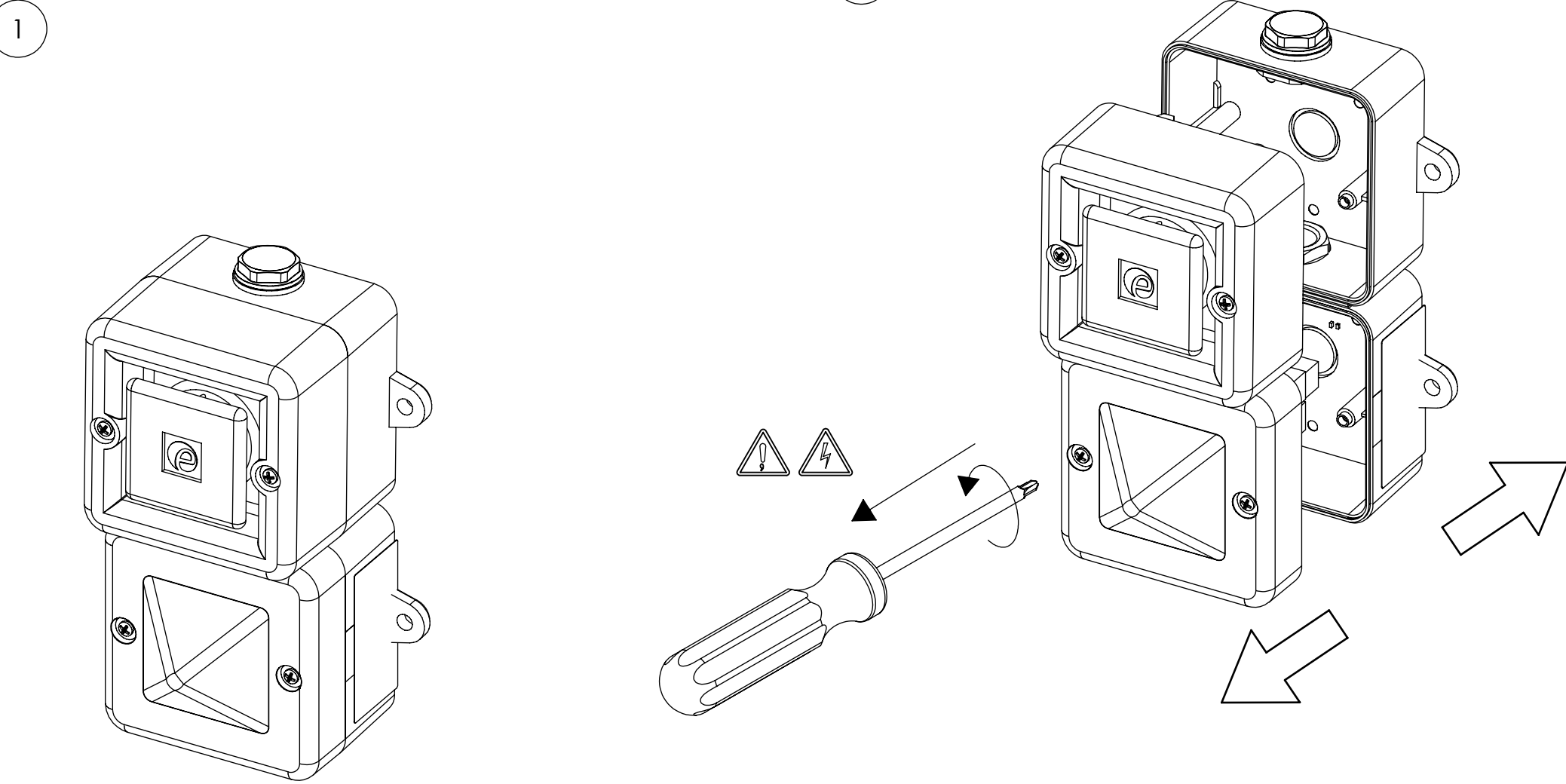

Tel : +44 (0)2 8743 8880 Fax : +44 (0)20 8740 4200
mail : sales@e2s.com web : www.e2s.com



B

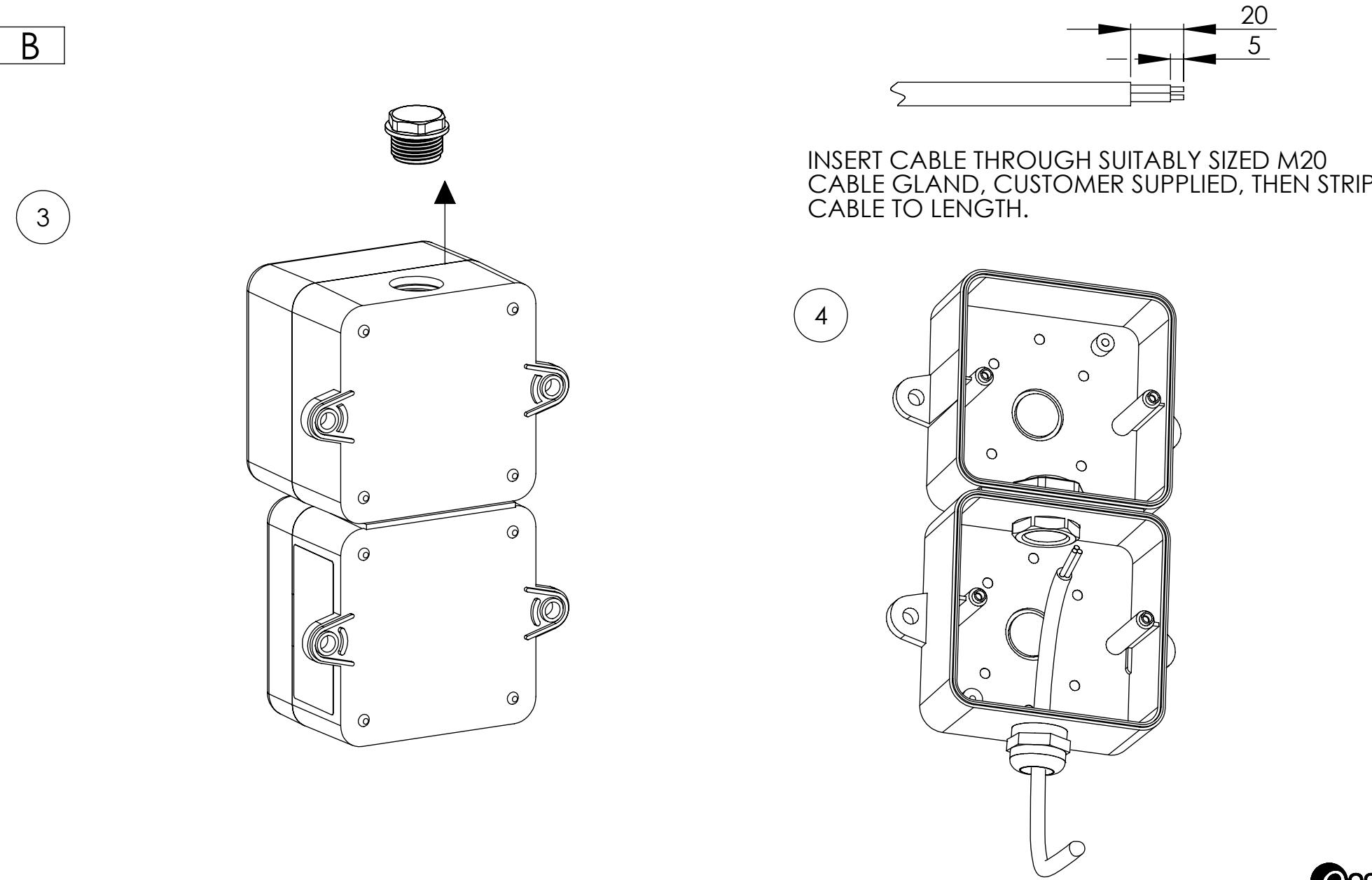

Dimensions in mm



C

TERMINAL BLOCK	A/C INPUT	D/C INPUT
\perp	N~	-
N/-	L~	+
S2	SWITCH TO C	SWITCH TO -
S3	SWITCH TO C	SWITCH TO -

CONNECT
CABLE AS
SHOWN

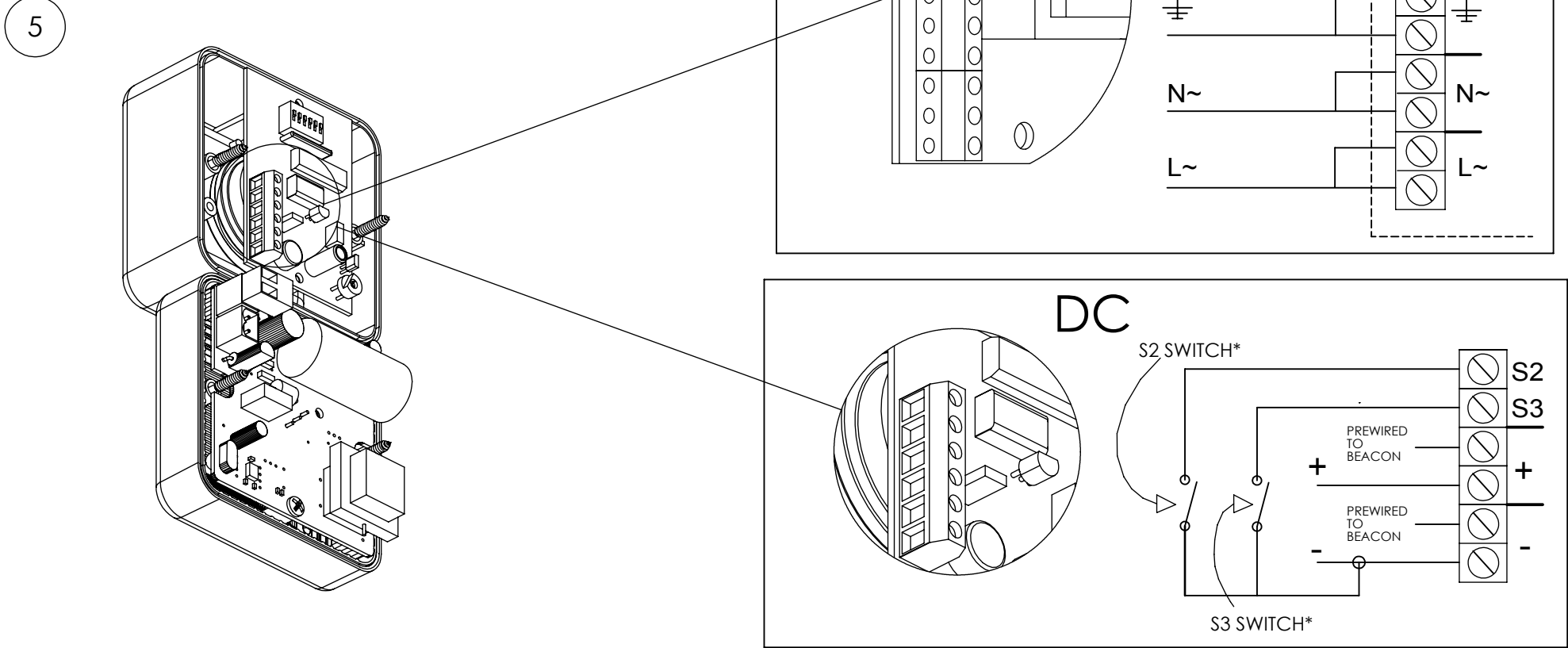

*S2 & S3 Denote Stage 2 & Stage 3 respectively
Stage switches are customer supplied



D

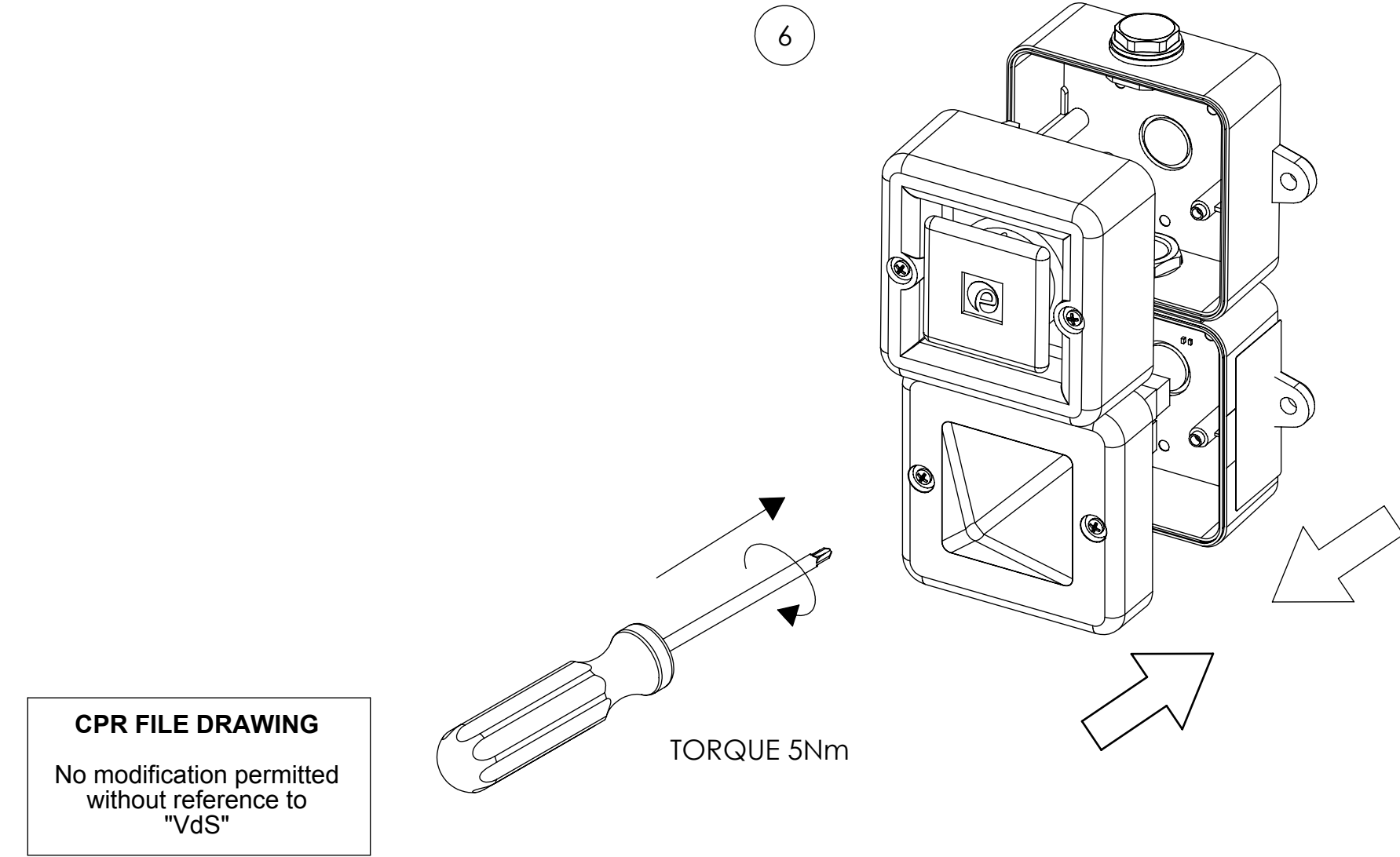

AL100XDC024 LIGHT OUTPUT

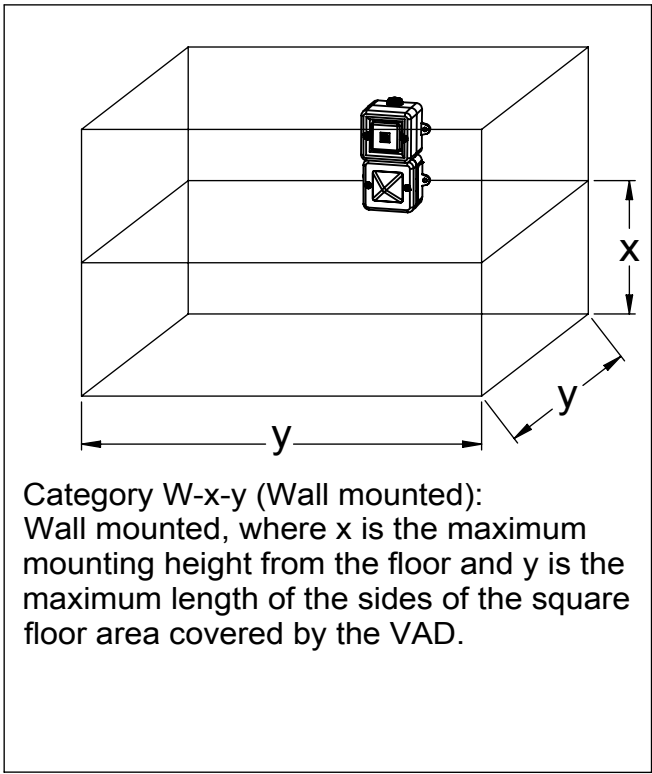

Note: CPR aproved units must be positioned sounder on top, beacon below.

Coverage Area According to EN54-23
(Only units in the following table are VdS Approved)

Unit	Category W	Power
AL100XDC024[x]/C	W-2.4-4.8	7W
	V=55.3m³	
AL100XDC048[x]/C	W-2.5-5	11W
	V=62.5m³	

CPR FILE DRAWING
No modification permitted
without reference to
"VdS"

Tel : +44 (0)2 8743 8880 Fax : +44 (0)20 8740 4200
mail : sales@e2s.com web : www.e2s.com



AL100XDC024 SOUND PRESSURE LEVEL OUTPUT

(TESTING AT MINIMUM VOLTAGE OF 18V DC.
ALL READINGS ARE IN dB(A) @ 1m)

AL100XDC024 HORIZONTAL POLAR PLOT

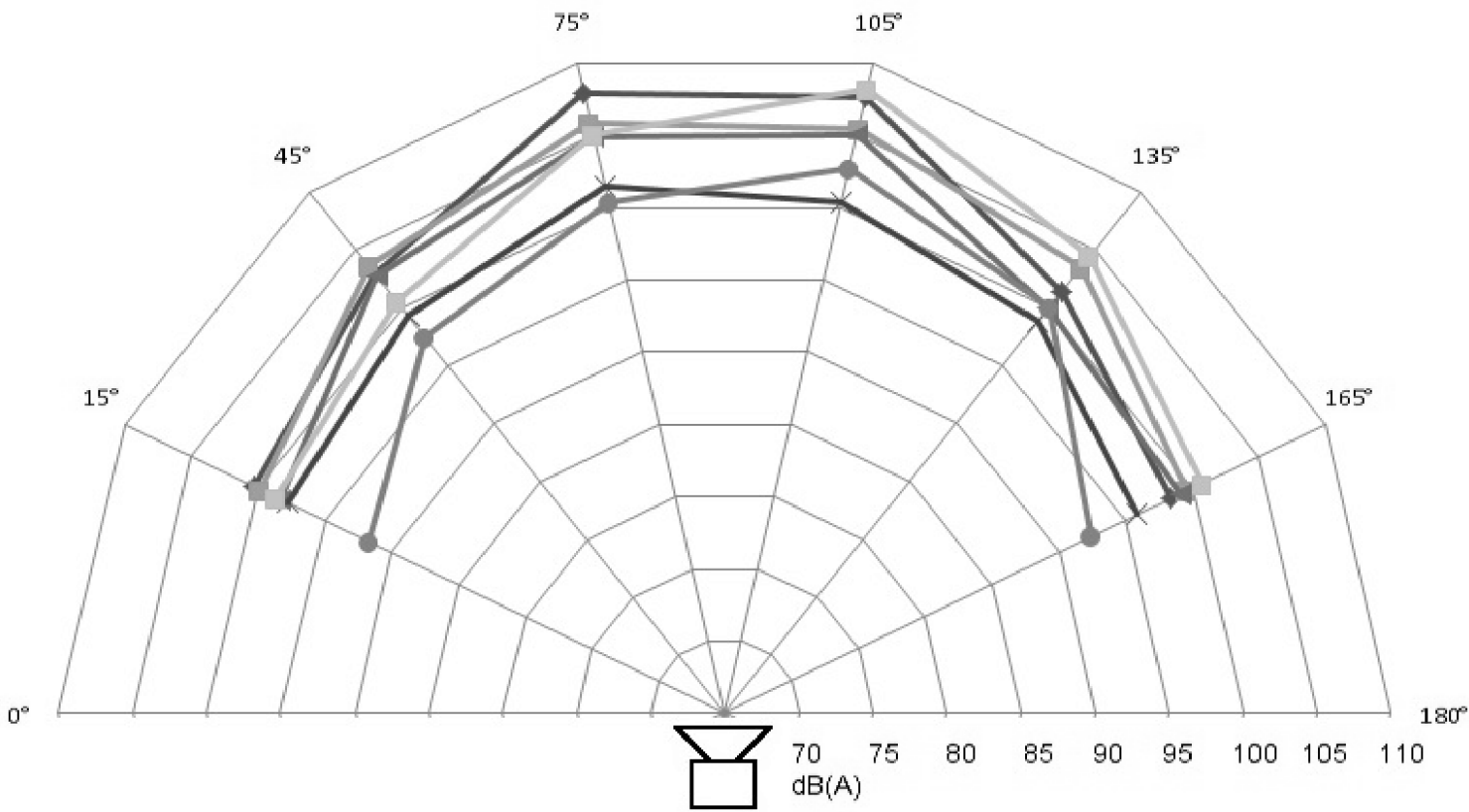

AL100XDC024 VERTICAL POLAR PLOT

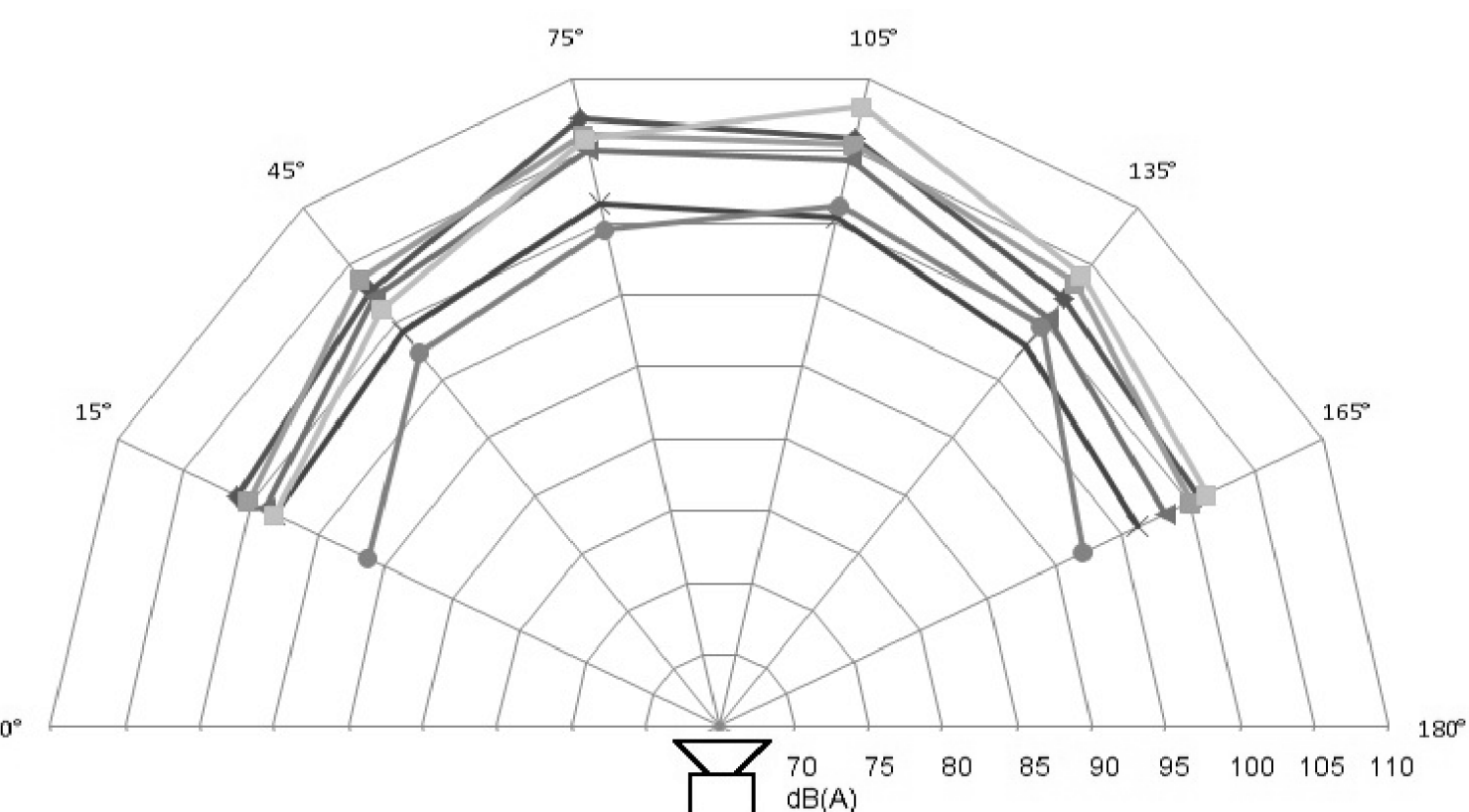

AL100XDC048 SOUND PRESSURE LEVEL OUTPUT

(TESTING AT MINIMUM VOLTAGE OF 35V DC.
ALL READINGS ARE IN dB(A) @ 1m)

AL100XDC048 HORIZONTAL POLAR PLOT

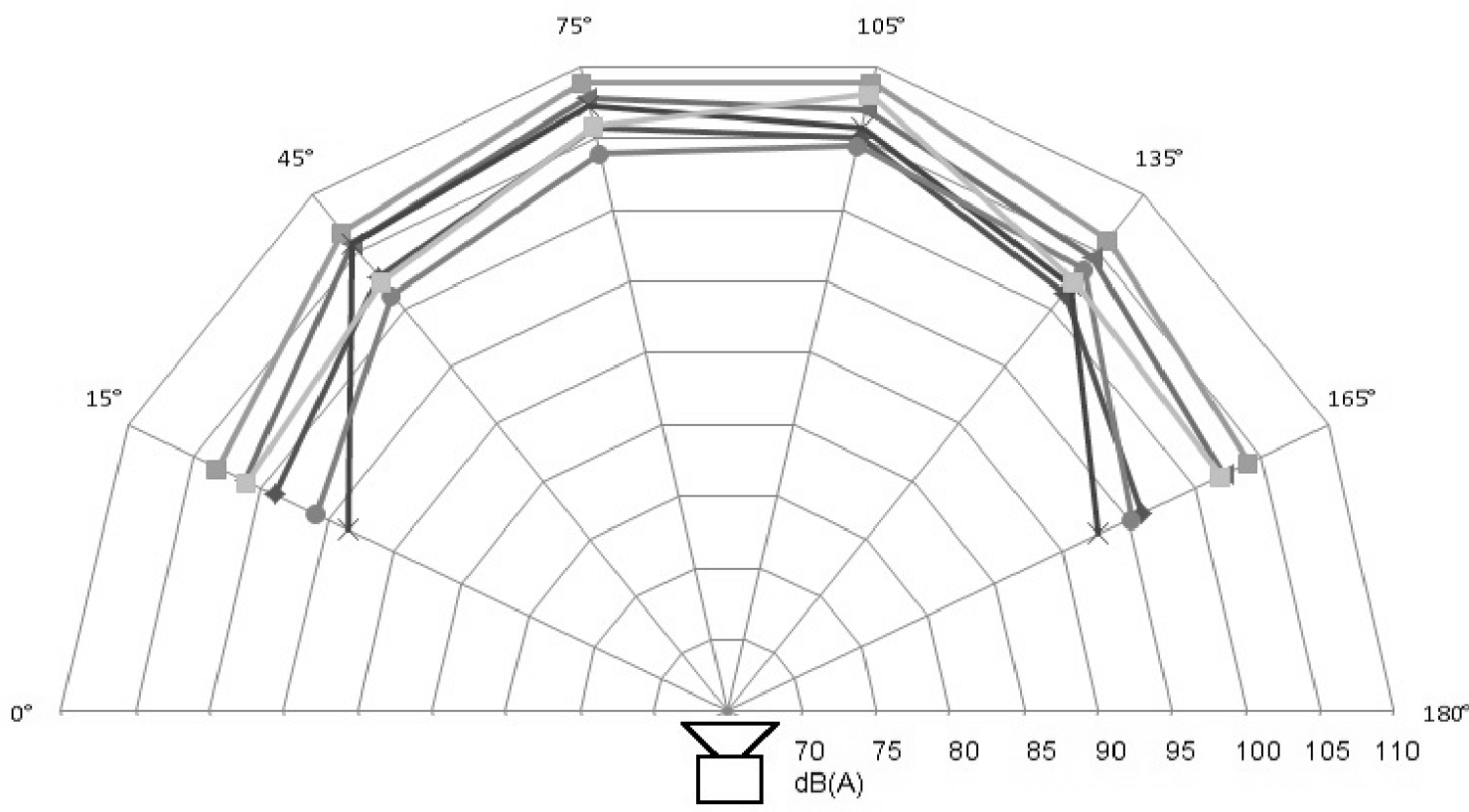

AL100XDC048 VERTICAL POLAR PLOT

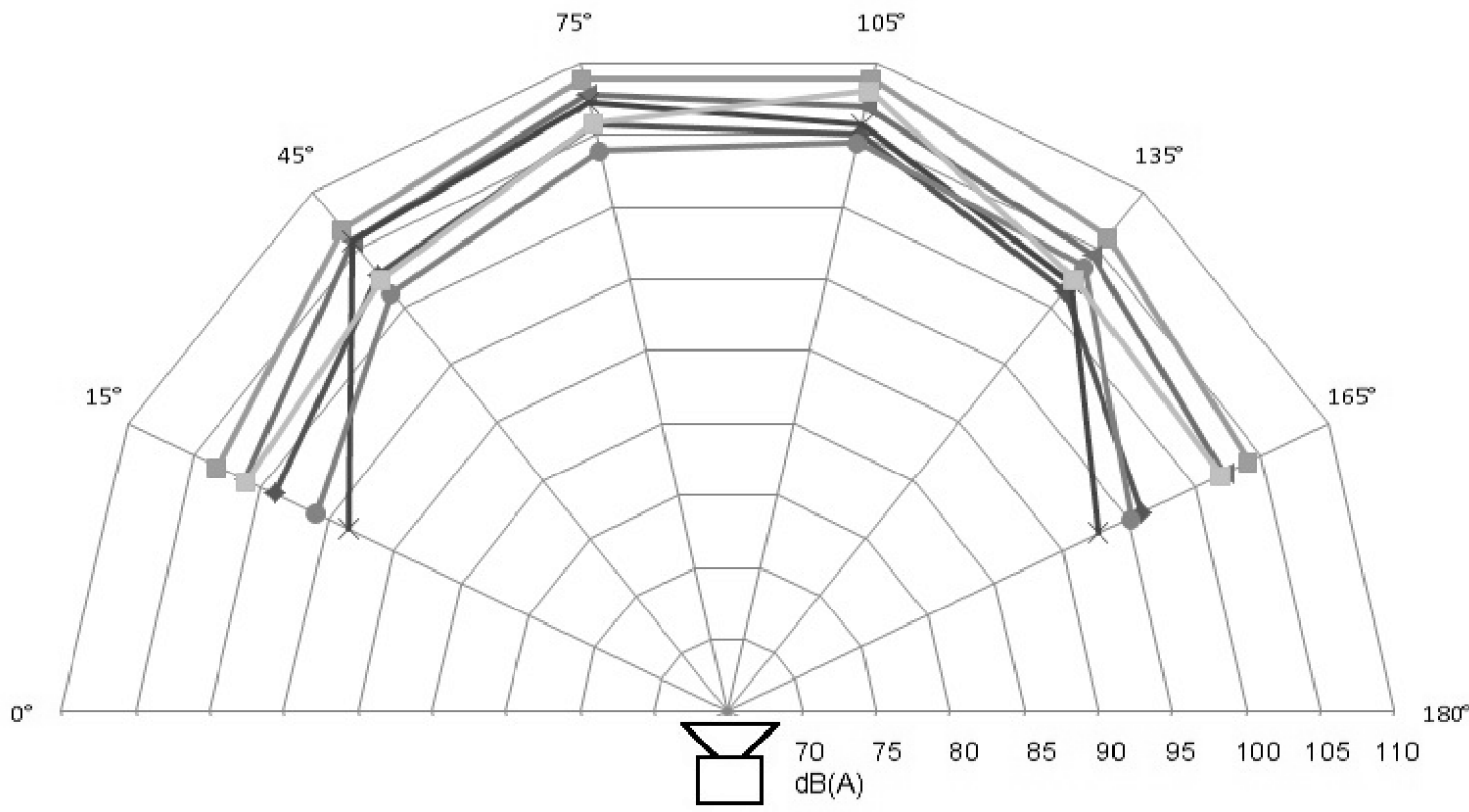

- ◆ Tone2
- Tone 3
- ▲ Tone 9
- ✕ Tone 15
- Tone 16
- Tone 17

